

JACKSONS NATURE WORKS

34 CALOOLA CRESCENT, BEVERLY HILLS 2209

9 150 4430
04 18) 414 502

The Secretary
Sylvanvale Head Office
PO Box 29
Sutherland NSW 1499

16th August 2022

Dear Sir,
RE: Arborists services at 147 Garnet Road, Kareela NSW – The Site

1. Background

A Planning proposal PP-2021-6325 has been determined to amend Sutherland Shire Local Environmental Plan 2015 for a Gateway determination under section 3.34(1) of the Environmental Planning and Assessment Act 1979 (the Act) in respect of the planning proposal to rezone land at 147 Garnet Road, Kirrawee to facilitate a residential flat building development with associated development standards on site (development works).

To prepare this report we have reviewed the following documents:

- Arboricultural Assessment Report by Jacksons Nature Works, dated 29.5.2020 (AAR/JNW 2020)
- Architectural plans by Couvaras Architects dated 26.7.2022, Rev P.
- Landscape plans by Site Design Studios dated 12.8.2022, Issue F.
- Sutherland Shire Council DCP Chapter 38 Natural Resources Management 2015 (DCP); &
- Australian Standard AS 4970 – 2009 Protection of trees on development sites.

This report will examine the revised design and provide Council with our discussions and recommendations for their approval.

2. Observations

The same tree numbering used in this report are those used in the AAR/JNW 2020 for ease of reference.

3. Discussions

3.1 The following comments are advised in response to Councils request and the modified design:

1. The following trees are proposed to be removed:

- a. Tree 31 *Eucalyptus pilularis*.
- b. Tree 32 *Eucalyptus pilularis*.
- c. Tree 33 *Angophora costata*.
- d. Tree 52 *Corymbia gummifera*.

- e. Tree 53A *Callistemon viminalis*.
- f. Tree 54 *Angophora costata*.
- g. Tree 54A *Glochidion ferdinandi*.
- h. Tree 55 *Angophora costata*.
- i. Tree 56 *Brachychiton acerifolia*.
- j. Tree 56A *Ficus benjamina*.
- k. Tree 57 *Eucalyptus pilularis*.
- l. Tree 57A *Banksia serrata*.
- m. Tree 57B *Eucalyptus sp.*
- n. Tree 57C *Eucalyptus sp.*
- o. Tree 58 *Melia azedarach*.
- p. Tree 59 *Banksia serrata*.
- q. Tree 60 *Banksia serrata*.
- r. Tree 64 *Cinnamomum camphora* (Exempt species).
- s. Tree 65 *Ceratopetalum gummifera*.
- t. Tree 87A *Celtis occidentalis*.
- u. Tree 119 *Corymbia gummifera*.
- v. Tree 132 *Corymbia gummifera*.

2. All of the remaining trees will be retained as part development works as noted in the AAR/JNW 2020 report.

3. A copy of the Site plan & Landscape plan can be found on Annexure A.

4. Recommendations

The report specifically recommends

- a. The removal of the following trees: Trees 31, 32, 33, 52, 53A, 54, 54A, 55, 56, 56A, 57, 57A, 57B, 57C, 58, 59, 60, 65, 87A, 119 & 132.
- b. The removal of the following Exempt species: Tree 64.
- c. All other trees noted in the AAR/JNW 2020 shall be retained.
- d. Tree removal work shall be carried out by an experienced tree surgeon in accordance with *Safe Work Australia Guide for Managing Risks of Tree Trimming and Removal (2016)*.
- e. Install the following Tree Protection Measures around the retained trees on site: tree protection measures shall be a temporary fence of chain wire panels 1.8 metres in height (or equivalent), supported by steel stakes or concrete blocks as required and fastened together and supported to prevent sideways movement. A sign is to be erected on the tree protection fences of the trees to be retained that the trees are covered by Council's tree preservation orders and that "No Access" is permitted into the tree protection zone.
- f. That a Tree Management Plan be prepared as part of the Construction Certificate.
- g. An AQF Level 5 Project Arborist shall be engaged to supervise the building works and certify compliance with all Tree Protection Measures.



Ross Jackson M.A.A. & M.A.I.H.
 Consulting Arborist 1695
 Graduate Certificate in Arboriculture AQF Level 8
 Diploma Horticulture (Arboriculture) – AQF Level 5
 Certificate III in Horticulture
 Certificate in Horticulture (Landscape – Honours)



LANDSCAPE CONCEPT (R2)

147 GARNET RD, KIRRAWEE NSW

Drawing List			
Drawn By	Rev. No.	Rev. Date	Project No.
Site Plan	A1	13/03/20	
Overall Landscape Plan	A1	13/03/20	
Proposed Landscape Plan	F	13/03/20	
Existing Tree Plan	A1	13/03/20	



LANDSCAPE PLAN
SCALE 1:400

LEGEND	
EXISTING TREES TO BE RETAINED	EXISTING TREES TO BE REMOVED
PROPOSED TREES	TREES TO BE REMOVED
PROPOSED TREES	

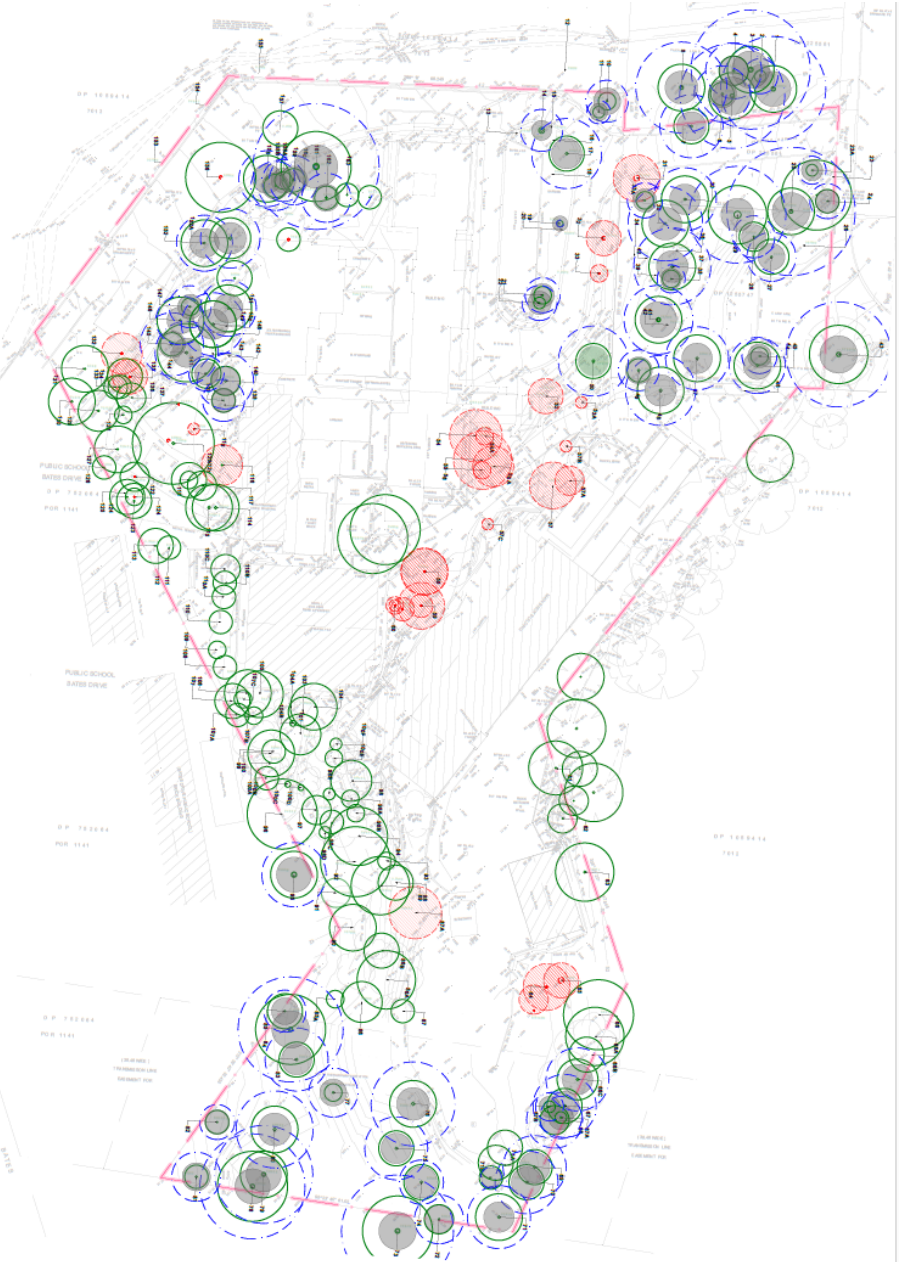

Tree ID	Species	Size	Color	Notes
1	Maple	12"	Green	
2	Oak	18"	Blue	
3	Pine	10"	Red	
4	Maple	15"	Green	
5	Oak	20"	Blue	
6	Pine	12"	Red	
7	Maple	14"	Green	
8	Oak	16"	Blue	
9	Pine	11"	Red	
10	Maple	13"	Green	
11	Oak	19"	Blue	
12	Pine	13"	Red	
13	Maple	17"	Green	
14	Oak	21"	Blue	
15	Pine	14"	Red	
16	Maple	16"	Green	
17	Oak	17"	Blue	
18	Pine	15"	Red	
19	Maple	18"	Green	
20	Oak	22"	Blue	
21	Pine	16"	Red	
22	Maple	19"	Green	
23	Oak	23"	Blue	
24	Pine	17"	Red	
25	Maple	20"	Green	
26	Oak	24"	Blue	
27	Pine	18"	Red	
28	Maple	21"	Green	
29	Oak	25"	Blue	
30	Pine	19"	Red	
31	Maple	22"	Green	
32	Oak	26"	Blue	
33	Pine	20"	Red	
34	Maple	23"	Green	
35	Oak	27"	Blue	
36	Pine	21"	Red	
37	Maple	24"	Green	
38	Oak	28"	Blue	
39	Pine	22"	Red	
40	Maple	25"	Green	
41	Oak	29"	Blue	
42	Pine	23"	Red	
43	Maple	26"	Green	
44	Oak	30"	Blue	
45	Pine	24"	Red	
46	Maple	27"	Green	
47	Oak	31"	Blue	
48	Pine	25"	Red	
49	Maple	28"	Green	
50	Oak	32"	Blue	
51	Pine	26"	Red	
52	Maple	29"	Green	
53	Oak	33"	Blue	
54	Pine	27"	Red	
55	Maple	30"	Green	
56	Oak	34"	Blue	
57	Pine	28"	Red	
58	Maple	31"	Green	
59	Oak	35"	Blue	
60	Pine	29"	Red	
61	Maple	32"	Green	
62	Oak	36"	Blue	
63	Pine	30"	Red	
64	Maple	33"	Green	
65	Oak	37"	Blue	
66	Pine	31"	Red	
67	Maple	34"	Green	
68	Oak	38"	Blue	
69	Pine	32"	Red	
70	Maple	35"	Green	
71	Oak	39"	Blue	
72	Pine	33"	Red	
73	Maple	36"	Green	
74	Oak	40"	Blue	
75	Pine	34"	Red	
76	Maple	37"	Green	
77	Oak	41"	Blue	
78	Pine	35"	Red	
79	Maple	38"	Green	
80	Oak	42"	Blue	
81	Pine	36"	Red	
82	Maple	39"	Green	
83	Oak	43"	Blue	
84	Pine	37"	Red	
85	Maple	40"	Green	
86	Oak	44"	Blue	
87	Pine	38"	Red	
88	Maple	41"	Green	
89	Oak	45"	Blue	
90	Pine	39"	Red	
91	Maple	42"	Green	
92	Oak	46"	Blue	
93	Pine	40"	Red	
94	Maple	43"	Green	
95	Oak	47"	Blue	
96	Pine	41"	Red	
97	Maple	44"	Green	
98	Oak	48"	Blue	
99	Pine	42"	Red	
100	Maple	45"	Green	
101	Oak	49"	Blue	
102	Pine	43"	Red	
103	Maple	46"	Green	
104	Oak	50"	Blue	
105	Pine	44"	Red	
106	Maple	47"	Green	
107	Oak	51"	Blue	
108	Pine	45"	Red	
109	Maple	48"	Green	
110	Oak	52"	Blue	
111	Pine	46"	Red	
112	Maple	49"	Green	
113	Oak	53"	Blue	
114	Pine	47"	Red	
115	Maple	50"	Green	
116	Oak	54"	Blue	
117	Pine	48"	Red	
118	Maple	51"	Green	
119	Oak	55"	Blue	
120	Pine	49"	Red	
121	Maple	52"	Green	
122	Oak	56"	Blue	
123	Pine	50"	Red	
124	Maple	53"	Green	
125	Oak	57"	Blue	
126	Pine	51"	Red	
127	Maple	54"	Green	
128	Oak	58"	Blue	
129	Pine	52"	Red	
130	Maple	55"	Green	
131	Oak	59"	Blue	
132	Pine	53"	Red	
133	Maple	56"	Green	
134	Oak	60"	Blue	
135	Pine	54"	Red	
136	Maple	57"	Green	
137	Oak	61"	Blue	
138	Pine	55"	Red	
139	Maple	58"	Green	
140	Oak	62"	Blue	
141	Pine	56"	Red	
142	Maple	59"	Green	
143	Oak	63"	Blue	
144	Pine	57"	Red	
145	Maple	60"	Green	
146	Oak	64"	Blue	
147	Pine	58"	Red	
148	Maple	61"	Green	
149	Oak	65"	Blue	
150	Pine	59"	Red	
151	Maple	62"	Green	
152	Oak	66"	Blue	
153	Pine	60"	Red	
154	Maple	63"	Green	
155	Oak	67"	Blue	
156	Pine	61"	Red	
157	Maple	64"	Green	
158	Oak	68"	Blue	
159	Pine	62"	Red	
160	Maple	65"	Green	
161	Oak	69"	Blue	
162	Pine	63"	Red	
163	Maple	66"	Green	
164	Oak	70"	Blue	
165	Pine	64"	Red	
166	Maple	67"	Green	
167	Oak	71"	Blue	
168	Pine	65"	Red	
169	Maple	68"	Green	
170	Oak	72"	Blue	
171	Pine	66"	Red	
172	Maple	69"	Green	
173	Oak	73"	Blue	
174	Pine	67"	Red	
175	Maple	70"	Green	
176	Oak	74"	Blue	
177	Pine	68"	Red	
178	Maple	71"	Green	
179	Oak	75"	Blue	
180	Pine	69"	Red	
181	Maple	72"	Green	
182	Oak	76"	Blue	
183	Pine	70"	Red	
184	Maple	73"	Green	
185	Oak	77"	Blue	
186	Pine	71"	Red	
187	Maple	74"	Green	
188	Oak	78"	Blue	
189	Pine	72"	Red	
190	Maple	75"	Green	
191	Oak	79"	Blue	
192	Pine	73"	Red	
193	Maple	76"	Green	
194	Oak	80"	Blue	
195	Pine	74"	Red	
196	Maple	77"	Green	
197	Oak	81"	Blue	
198	Pine	75"	Red	
199	Maple	78"	Green	
200	Oak	82"	Blue	
201	Pine	76"	Red	
202	Maple	79"	Green	
203	Oak	83"	Blue	
204	Pine	77"	Red	
205	Maple	80"	Green	
206	Oak	84"	Blue	
207	Pine	78"	Red	
208	Maple	81"	Green	
209	Oak	85"	Blue	
210	Pine	79"	Red	
211	Maple	82"	Green	
212	Oak	86"	Blue	
213	Pine	80"	Red	
214	Maple	83"	Green	
215	Oak	87"	Blue	
216	Pine	81"	Red	
217	Maple	84"	Green	
218	Oak	88"	Blue	
219	Pine	82"	Red	
220	Maple	85"	Green	
221	Oak	89"	Blue	
222	Pine	83"	Red	
223	Maple	86"	Green	
224	Oak	90"	Blue	
225	Pine	84"	Red	
226	Maple	87"	Green	
227	Oak	91"	Blue	
228	Pine	85"	Red	
229	Maple	88"	Green	
230	Oak	92"	Blue	
231	Pine	86"	Red	
232	Maple	89"	Green	
233	Oak	93"	Blue	
234	Pine	87"	Red	
235	Maple	90"	Green	
236	Oak	94"	Blue	
237	Pine	88"	Red	
238	Maple	91"	Green	
239	Oak	95"	Blue	
240	Pine	89"	Red	
241	Maple	92"	Green	
242	Oak	96"	Blue	
243	Pine	90"	Red	
244	Maple	93"	Green	
245	Oak	97"	Blue	
246	Pine	91"	Red	
247	Maple	94"	Green	
248	Oak	98"	Blue	
249	Pine	92"	Red	
250	Maple	95"	Green	
251	Oak	99"	Blue	
252	Pine	93"	Red	
253	Maple	96"	Green	
254	Oak	100"	Blue	
255	Pine	94"	Red	
256	Maple	97"	Green	
257	Oak	101"	Blue	
258	Pine	95"	Red	
259	Maple	98"	Green	
260	Oak	102"	Blue	
261	Pine	96"	Red	
262	Maple	99"	Green	
263	Oak	103"	Blue	
264	Pine	97"	Red	
265	Maple	100"	Green	
266	Oak	104"	Blue	
267	Pine	98"	Red	
268	Maple	101"	Green	
269	Oak	105"	Blue	
270	Pine	99"	Red	
271	Maple	102"	Green	
272	Oak	106"	Blue	
273	Pine	100"	Red	
274	Maple	103"	Green	
275	Oak	107"	Blue	
276	Pine	101"	Red	
277	Maple	104"	Green	
278	Oak	108"	Blue	
279	Pine	102"	Red	
280	Maple	105"	Green	
281	Oak	109"	Blue	
282	Pine	103"	Red	
283	Maple	106"	Green	
284	Oak	110"	Blue	
285	Pine	104"	Red	
286	Maple	107"	Green	
287	Oak	111"	Blue	
288	Pine	105"	Red	
289	Maple	108"	Green	
290	Oak	112"	Blue	
291	Pine	106"	Red	
292	Maple	109"	Green	
293	Oak	113"	Blue	
294	Pine	107"	Red	
295	Maple	110"	Green	
296	Oak	114"	Blue	
297	Pine	108"	Red	
298	Maple	111"	Green	
299	Oak	115"	Blue	
300	Pine	109"	Red	
301	Maple	112"	Green	
302	Oak	116"	Blue	
303	Pine	110"	Red	
304	Maple	113"	Green	
305	Oak	117"	Blue	
306	Pine	111"	Red	
307	Maple	114"	Green	
308	Oak	118"	Blue	
309	Pine	112"	Red	
310	Maple	115"	Green	
311	Oak	119"	Blue	
312	Pine	113"	Red	
313	Maple	116"	Green	
314	Oak	120"	Blue	
315	Pine	114"	Red	
316	Maple	117"	Green	
317	Oak	121"	Blue	
318	Pine	115"	Red	
319	Maple	118"	Green	
320	Oak	122"	Blue	
321	Pine	116"	Red	
322	Maple	119"	Green	
323	Oak	123"	Blue	
324	Pine	117"	Red	
325	Maple	120"	Green	
326	Oak	124"	Blue	
327	Pine	118"	Red	
328	Maple	121"	Green	
329	Oak	125"	Blue	
330	Pine	119"	Red	
331	Maple	122"	Green	
332	Oak	126"	Blue	
333	Pine	120"	Red	
334	Maple	123"	Green	
335	Oak	127"	Blue	
336	Pine	121"	Red	
337	Maple	124"	Green	
338	O			